

Mark Goldman & Associates

Lake Iliamna Area Villages' Regional Justice Center

The Native Villages:

Iliamna
Igiugig
Kokhanok
Newhalen
Nondalton
Pedro Bay
Port Alsworth

Program:

Regional Justice Center with
Tribal Courts, Healing /
Rehabilitative Programs &
Law Enforcement

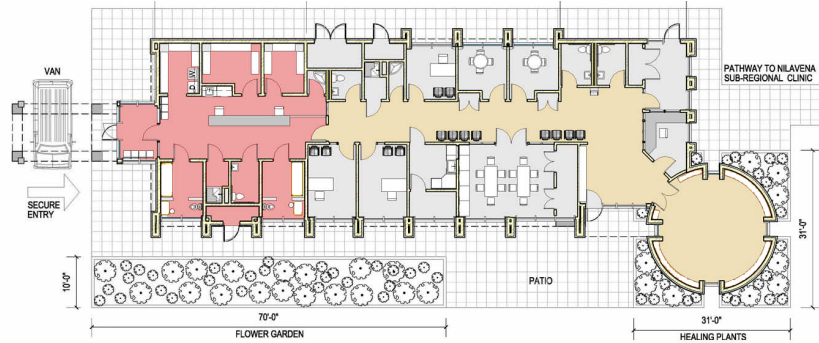

Mission:

“The mission of the Regional Justice Center for the Villages of the Lake Iliamna Area is to protect our people; to promote justice, culture, rehabilitation, and the well-being of our people; and to provide the tools to help our people live law-abiding, productive & healthy lives.”

Description:

Mark Goldman & Associates studied the existing justice and social service systems in the seven Villages and developed an operational and architectural program, master plan, staffing plan, conceptual design; estimated costs; and assisted with funding options for a Regional Justice Center. Currently these Villages have sparse resources and virtually no justice facilities.

The facility will be focused on “healing.” The facility design incorporates cultural elements that are important to the seven Native Villages and rehabilitative elements based on “best practices.”

Estimated Cost:

\$3.21 million

Completion:

2015 – Needs Assessment,
Master Plan & Conceptual
Design

Planners:

Mark Goldman
Dita Peatross
Peter Krasnow, FAIA

